

E.M.I. Suppressors RH Series

1 Applications

The RH Series is used for EMI Suppression on round Cables

2 Materials

Ly3A, Ly3B, Ly5
Ly5B, Ly6, Ly6A

3 Order Codes

<u>Ly5B</u>	<u>RH</u>	<u>31</u>	X	<u>35</u>	X	<u>19</u>
Material	Type	OD		H		ID
		A		B		C

Lengths can be changed to suit Custom Requirements

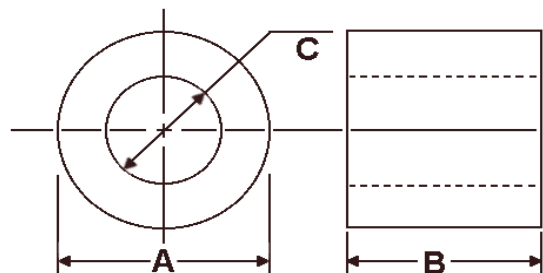
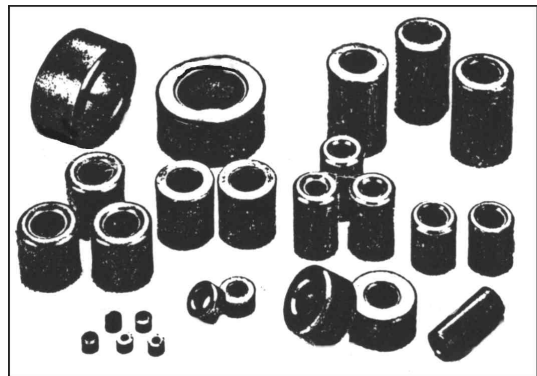

Item (Pt. No.)	A	+/-	B	+/-	C	+/-
RH 3.5 x 3 x 1.35	3.5	0.15	3.0	0.3	1.35	0.1
RH 3.5 x 6 x 1.35	3.5	0.15	6.0	0.3	1.35	0.1
RH 3.5 x 3 x 1.55	3.5	0.15	3.0	0.3	1.55	0.1
RH 3.5 x 6 x 1.55	3.5	0.15	6.0	0.3	1.55	0.1
RH 3.5 x 3 x 2.0	3.5	0.15	3.0	0.3	2	0.1
RH 3.5 x 6 x 2.0	3.5	0.15	6.0	0.3	2	0.1
RH 3.5 x 9 x 2.0	3.5	0.15	9.0	0.3	2	0.1
RH 4 x 2 x 1.5	4.0	0.15	2.0	0.2	1.5	0.1
RH 4 x 10 x 1.5	4.0	0.15	10.0	0.3	1.5	0.1
RH 4 x 3 x 2	4.0	0.15	3.0	0.3	2	0.1
RH 4 x 10 x 2	4.0	0.15	10.0	0.3	2	0.1
RH 4.5 x 4.5 x 1	4.5	0.15	4.5	0.3	1	0.1
RH 4.5 x 9 x 1	4.5	0.15	9.0	0.3	1	0.1
RH 6 x 1.5 x 3	6.0	0.15	1.5	0.3	3	0.15
RH 6 x 3 x 3	6.0	0.15	3.0	0.3	3	0.15
RH 6 x 6 x 3	6.00	0.15	6.0	0.3	3	0.1
RH 6.6 x 6.6 x 1	6.6	0.2	6.6	0.3	1	0.1
RH 6.6 x 10 x 1	6.6	0.2	10.0	0.3	1	0.1
RH 8 x 4 x 1	8.0	0.2	4.0	0.3	1	0.1
RH 8 x 8 x 1	8.0	0.2	8.0	0.3	1	0.1
RH 8 x 20 x 1	8.0	0.2	20.0	0.5	1	0.1
RH 8 x 15 x 3.4	8.0	0.2	15.0	0.5	3.4	0.2
RH 8 x 20 x 3.4	8.0	0.2	20.0	0.5	3.4	0.2
RH 9.53 x 5 x 4.75	9.53	0.3	5.0	0.3	4.75	0.3
RH 9.53 x 10.4 x 4.75	9.53	0.3	10.4	0.5	4.75	0.3
RH 9.53 x 20 x 4.75	9.53	0.3	20.0	0.5	4.75	0.3
RH 10 x 7.5 x 7	10.0	0.3	7.5	0.3	7	0.3
RH 10 x 20 x 7	10.0	0.3	20.0	0.5	7	0.3

Item (Pt. No.)	A	+/-	B	+/-	C	+/-
RH 12 x 20 x 5.6	12.0	0.3	20.0	0.5	5.6	0.3
RH 12 x 40 x 5.6	12.0	0.3	40.0	1.0	5.6	0.3
RH 12 x 20 x 6.8	12.0	0.3	20.0	0.5	6.8	0.3
RH 12 x 40 x 6.8	12.0	0.3	40.0	1.0	6.8	0.3
RH 12 x 15 x 7.3	12.0	0.3	15.0	0.5	7.3	0.3
RH 12 x 20 x 7.3	12.0	0.3	20.0	0.5	7.3	0.3
RH 12 x 40 x 7.3	12.0	0.3	40.0	1.0	7.3	0.3
RH 12.8 x 15 x 5.6	12.8	0.3	15.0	0.5	5.6	0.3
RH 12.8 x 20 x 5.6	12.8	0.3	20.0	0.5	5.6	0.3
RH 12.8 x 15 x 6.8	12.8	0.3	15.0	0.5	6.8	0.3
RH 12.8 x 20 x 6.8	12.8	0.3	20.0	0.5	6.8	0.3
RH 12.8 x 15 x 8	12.8	0.3	15.0	0.5	8	0.3
RH 12.8 x 20 x 8	12.8	0.3	20.0	0.5	8	0.3
RH 12.8 x 40 x 8	12.8	0.3	40.0	1.0	8	0.3
RH 14.3 x 28.5 x 6.35	14.3	0.4	28.5	0.8	6.35	0.3
RH 14.3 x 28.5 x 7.1	14.3	0.4	28.5	0.8	7.1	0.3
RH 16 x 17 x 9	16.0	0.5	17.0	0.5	9	0.3
RH 16 x 28.5 x 9	16.0	0.5	28.5	0.8	9	0.3
RH 17.5 x 12.7 x 9.5	17.5	0.5	12.7	0.5	9.5	0.3
RH 17.5 x 28.5 x 9.5	17.5	0.5	28.5	0.8	9.5	0.3
RH 17.5 x 20 x 10	17.5	0.5	20.0	0.5	10	0.3
RH 17.5 x 28.5 x 10	17.5	0.5	28.5	0.8	10	0.3
RH 17.5 x 28.5 x 10.7	17.5	0.5	28.5	0.8	10.7	0.3
RH 26 x 28 x 13	26.0	0.6	28.0	0.8	13	0.4
RH 28 x 20 x 16	28.0	0.6	20.0	0.5	16	0.5
RH 31 x 16 x 19	31.0	0.8	16.0	0.5	19	0.5
RH 31 x 35 x 19	31.0	0.8	35.0	1.0	19	0.5

All Dimensions are in mm